

Electrolysis Sterilization Water System

# C+Water

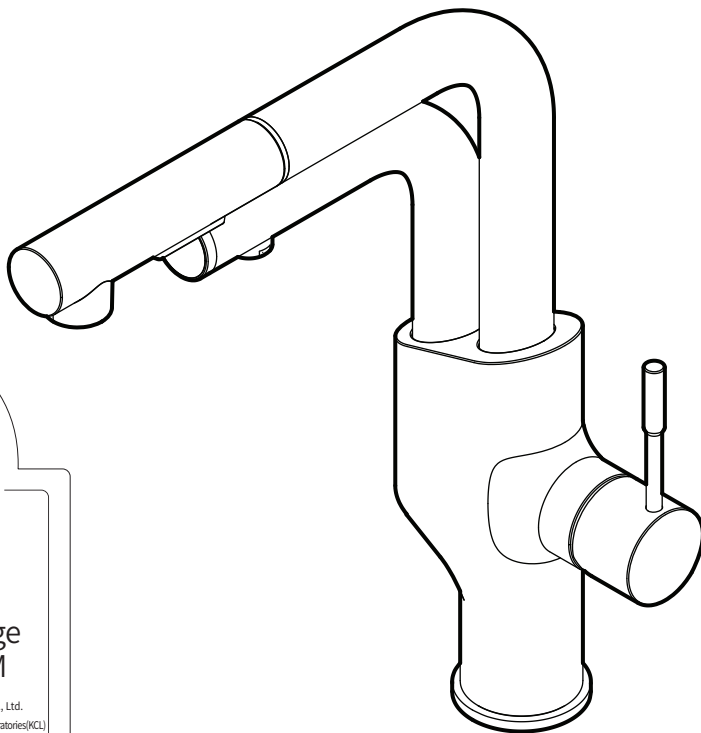

## DUAL KITCHEN CARE SOLUTION

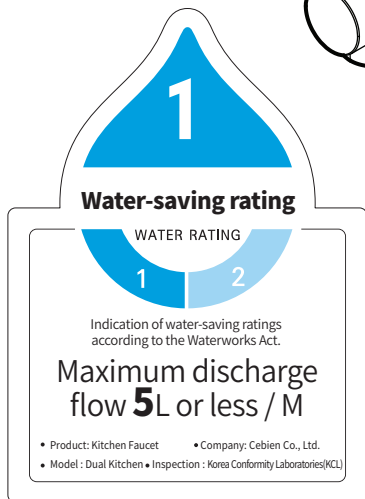

- Please read the installation and instruction for proper use of this product.
- This installation and instruction manual contains a product warranty.
- Some internal and external changes may be made to improve the performance of the product.
- This product is for home use. It is prohibited to use for commercial and experimental purposes, and separate product warranty regulations follow when used for commercial purposes.
- The illustrations in the manual are intended to help you understand the installation and use, and may be partially different from the actual shape.



# 1 Cautions for Safety (Requires stringent compliance for safety)

---

The manual entails crucial details on damages or injuries that may be inflicted for users, and thus shall be read thoroughly before installation or use.

Keep manual well so that it can be referred to at any time.

- This appliance can be used by children aged from 3 years and above and persons with reduced physical, sensory or mental capabilities or lack of experience and knowledge if they have been given supervision or instruction concerning use of the appliance in a safe way and understand the hazards involved.
- Children shall not play with the appliance.
- Cleaning and user maintenance shall not be made by children without supervision.
- The outlet must not be connected to any tap or fitting other than those specified.
- The water inlet of this appliance shall not be connected to inlet water obtained from any other water heating system.
- If the supply cord is damaged, it must be replaced by the manufacturer, its service agent or similarly qualified persons in order to avoid a hazard.



**Warning** | Details that may cause possible fatality or critical injury when breached.



**Caution** | Details that may cause injury or physical damage when breached



**Ban** || Highlights items that should be banned from doing



**Forced Instructions** | Highlights items that need to be abided by

- All damages that arise from situations like earthquake, lightning, flood that are exempt from the company's liability, actions by a 3rd party, other accidents and intended action by consumer or misuse/abuse shall not be subject to the company's responsibility.
- The company shall not be liable for subsidiary damage (business profit loss, business halt, etc.) that result from product use or not being able to use product .
- The company shall not be liable for all damages that arise from not abiding by the details of the manual .

### Safety Warning



BAN

Do not connect power to product that is not installed and has no water hose connection.

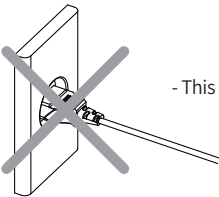

- This has risks of heat or fire.



BAN

Use separately power voltage of 220V with rating over 10A. .

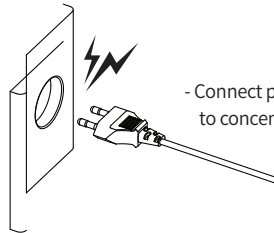

- Connect power adapter to concentric plug



BAN

Connect power adapter to concentric plug  
Do not use broken product as it is.  
Do not use product for purposes other than stipulated in user manual.

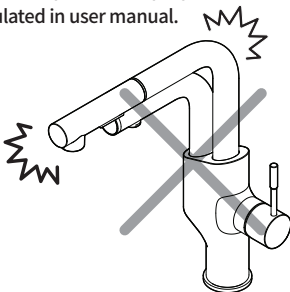

BAN

Do not pour water on product main body or adapter.  
Refrain from using at places with high humidity.

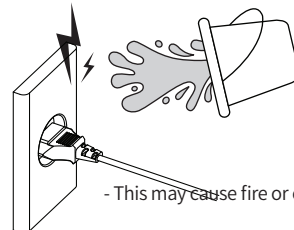

- This may cause fire or electric shock.

## Cautions for Safety (Requires stringent compliance for safety)



Connect water hose to waterworks only.  
Refrain from connecting underground water  
or industrial water to product



- This may cause product malfunction and downgrade in sterilization and cleaning function.



Do not use damaged power adapter or  
loose concentric plug

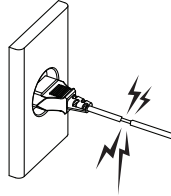

- Power adapter shall be fixed only by manufacturer, vendor or certified technicians.  
- This may cause fire or electric shock.



Do not dis-assemble, fix or reform product.  
Make sure no foreign substances go inside product.

Disassemble,  
Remodel Ban

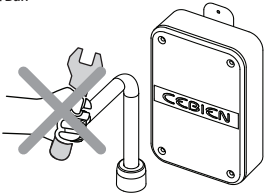

- This may cause or electric shock.



Unplug power adapter from plug for safety when  
cleaning exterior or disassembling product.

Power/Adapter  
Disconnection

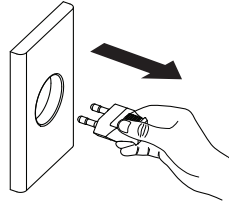

## ⚠ Cautions for Safety



When cleaning, do not spray or use cleaning agent  
(with acidity, for gas range, sink, toilet, bathroom,  
benzene, paint thinner, cleanser or other stain r  
emovers) on product exterior.

BAN



- Using above detergents may cause product surface color change (corrosion), damage and power-related issues.



Do not forcefully pull or bend the water supply hose  
and power cord.

BAN

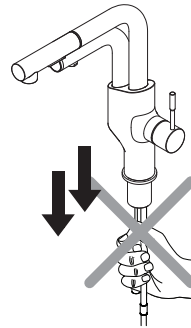

The body is for fixing and  
do not try to pull it.

BAN

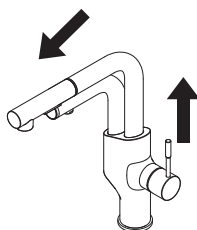

- A damaged power cord is dangerous and must be replaced  
by the manufacturer, dealer or qualified person.

- This device is not intended for use by persons including  
children who lack physical, sensory or mental abilities or  
who lack the experience and knowledge to be able to use  
this device safely without supervision or direction.

- Please make sure that children do not play with this device.

# 2

## Name of parts

---

---

### Main Body

---

Main Body(1)

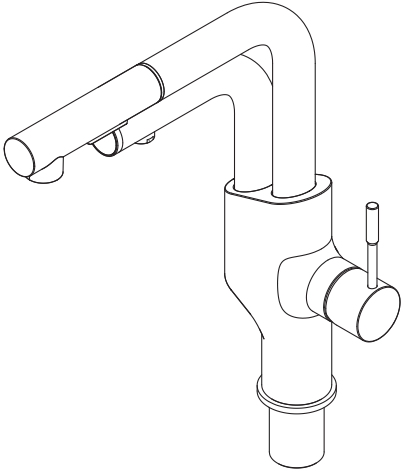

Main box(1)

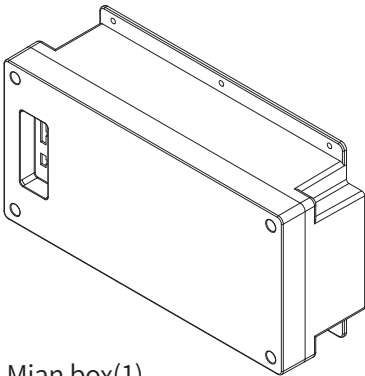

---

### Components

---

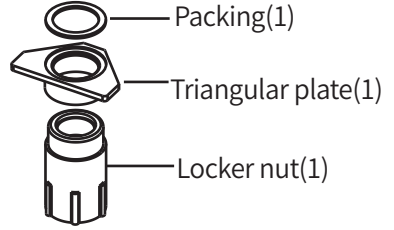

Locker nut set(1)



High pressure hose(1)



Main box locker piece(2)



Shunt valve(1)

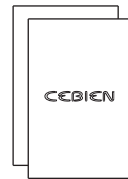

installation manual(1)

---

# 3 Installation

## Preparation

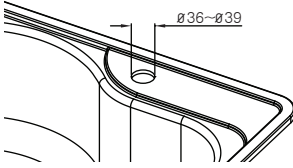

- 1 Before installation, check whether installation hole is  $\varnothing 36 - \varnothing 39$ .

Caution: When installing, check whether rubber packing is attached (its absence can lead to water leakage). Adding too much force can cause damage.

3. Install shunt valve.  
Rubber packing

- 3 Install shunt valve.

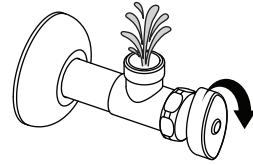
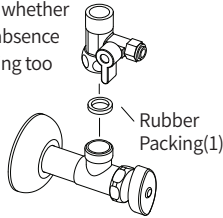

- 2 Before installation, flow water through water supply valve to remove foreign substances like sand,.

## Product installation

Main body installation

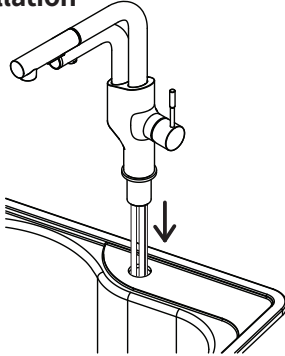

Put the product body into the installation hole so that the hose and electric wire are not twisted and attach the product closely.

Under the sink

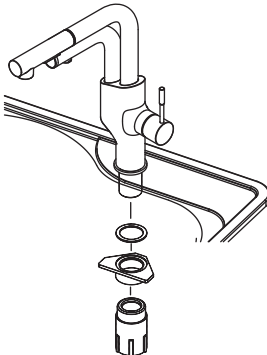

After assembling the packing and the triangular plate to the lower threaded part of the product body, firmly assemble it with the locker nut.

# Installation

## Main box installation

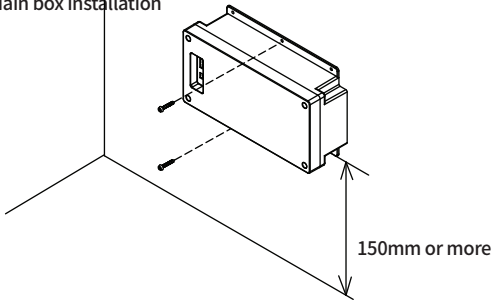

Install the main box on the side under the sink, right side recommended. Install at a height of 150mm or more from the floor, and avoid structures such as piping and drainage lines that interfere with the surroundings.

## Sink hose connection and weight installation

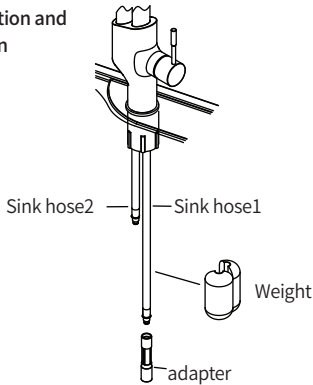

After assembling sink hose 1 and adapter of the product body, assemble sink hose 2 (one-touch method).

Fix the weight at a point 60cm from the end of the sink. When installing the weight, be careful not to loosen the lock device and fix it.

In case of interference depending on the installation environment, change the position of the weight and install it.

## hose installation

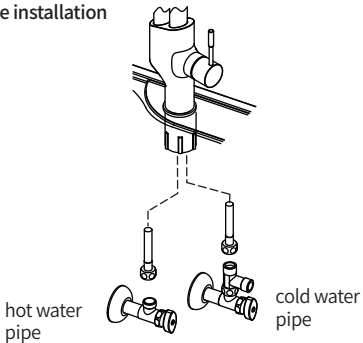

Install the water supply hose (hot/cold water) of the product body. Be careful not to twist the water supply hose during installation.

## Installation of the sterilizing water supply and outlet hoses.

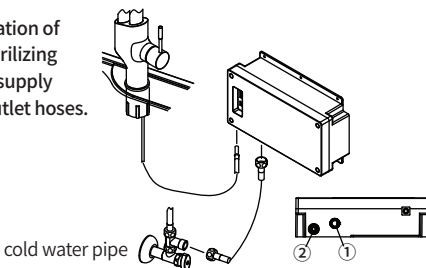

1) Connect the sterilizing water supply hose to the shunt valve of the cold water pipe and the inlet (①) of the main box.

2) Connect the sterilizing water outlet hose of the product body to the outlet (②) of main box.

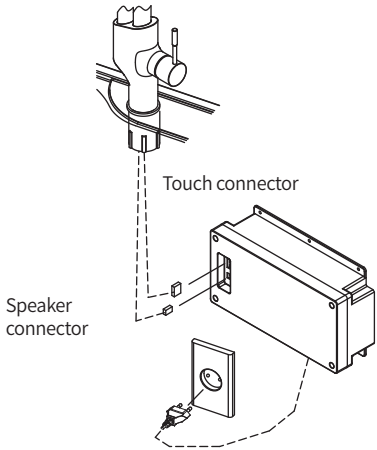

### Connector and power cord connection

Connect the touch connector and speaker connector of the product body to the connector of the main box.  
Connect the power cord of the main box to a power outlet.

## | Confirmation after installation

1) Water leakage check : With the water supply valve open, check that there is no water leaking from the piping connections.

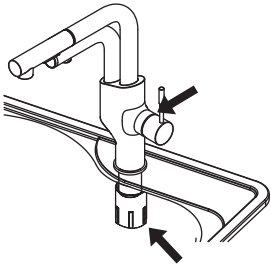

Body leakage check  
- Handle operation part,  
sink lower locker nut

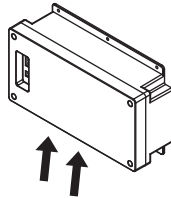

Mainbox leakage check  
- hose assembly

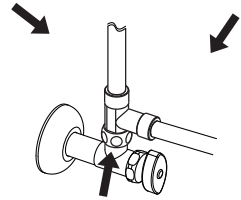

Piping and hose connections  
leakage check

2) Operation check [Power]: Connect the power cord to the outlet, and the lamp flickers on the touch part of the product body. If [White] does not light up, check if the power cord is properly connected.

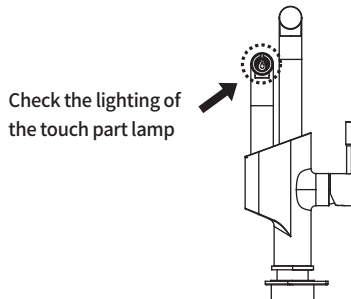



# 4 How to use

## 1. How to use the sink faucet

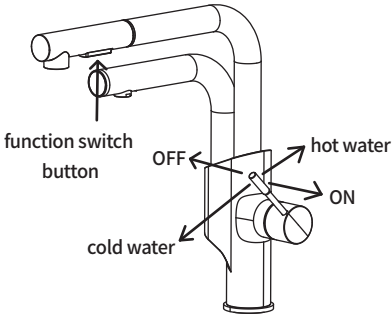

### 1) Flow control

- When the lever is opened to the right, water comes out.
- The amount of water is adjusted according to the action of opening the lever to the right.
- When the lever is closed to the left, water does not come out.

### 2) Temperature control

- When the lever is pulled toward the front part, the water discharge temperature decreases, and when the lever is pushed toward the rear side, the water discharge temperature increases.

### 3) How to convert spray and foam (direct water)

- If you press the button on the sink head during use, the function is switched.

## 2. How to use electrolysis water

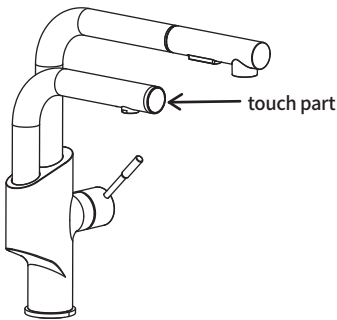

- 1) Electrolysis sterilization water is operated by touch method. When you touch it once, electrolysis sterilization water (cold water) comes out, and when you touch it twice, the water discharge stops. If you touch the touch part for 3 seconds in the standby state, electrolysis sterilization water (tepid water) comes out, and the water jetting stops when you touch it twice.

### 2) Indication of lamps during operation

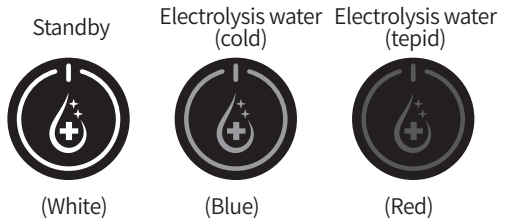

# 5

## Matters to Check Ahead of Malfunction Report

Case	Things to check
Water not coming out	Check if the water is cut off
	Check if the valve is closed
	See if the packing between valve is on the way
	Check if Airtator is blocked
When it's not operating	Check if the adaptor is connected to the outlet
	Check if main body is turned off
When there's leakage	Check if hoses are connected properly
	Contact service center if water is leaking from the product
Weak water flow	Check if there is impurity in the packing/airrator
Product turbulence	Make the fixation nut tighter
When it's not functioning	Check if the power is being supplied well
	Check if the adaptor is plugged in fully
	Remove impurities on the touch sensor part

# 6 Product Specifications

Model Name(Korean)	Electric Water Ionizer	씨-워터 듀얼키친
Model Name(English)	C-Water Dual Kitchen	
Model No.	F-CW0201	
Safety Certification No.	KCW-2021-0294	
Registration No.	R-R-PWk-F-CW0202	
Size	Main body 136*328*316 (mm)	
	Main Box 285*171*83 (mm)	
Main material	Brass, ABS, Insoluble Electrode, PE	
Rated voltage and frequency	230V~, 50Hz	
Normal Rated Power	1250W	
Hot water temperature	Max 32°C	
Amount of emission	Normal water : 5.51l or less /min	Max water (Base on 98kPa)
	Sterilization water 1.21l /min	
Lead leaching	1 ug or less / L	
Manufacturer	Cebien Co., Ltd.	
Country of origin	Made in KOREA	
Product weight	4.6kg	include install parts
Use environment	Water supply method	Directly connected to waterworks
	Use temperature	5°C ~ 35°C
	Use pressure	98kPa ~ 686 kPa (1kgf/cm <sup>2</sup> ~ 7kgf/cm <sup>2</sup> )
	Suggested use temperature	196kPa or more(2kgf or more /cm <sup>2</sup> )
	Purpose	indoor only

# Product Warranty

## CEBIEN Product Customer Service

- According to the consumer compensation standards, CEBIEN compensates for the products as follow:
- In case of a product malfunctions, please contact your dealer.  
(If you cannot contact the dealer, contact customer service team of CEBIEN.)

Model name		Date of purchase		Dealer	
Contractor (vendor)				Contact point	

- This product is for home use, the warranty period is 2 years, and the parts retention period is 3 years.

## Free service

- If you use the product for business purpose, your warranty will be shortened by half.

Types of consumer damage		Remuneration contents	
		Within warranty	After warranty
When critical repair is needed within 1 month after purchase due to performance or functional defect occurs during the normal use.		Free repair	-
Repairable	The same defects occur up to 3 times	Free repair	Paid repair
Unrepairable	Unable to repair due to un-retention parts	-	Cannot be repaired

## Paid Service

### ① If it is not malfunction

If it is not a malfunction, please refer to the service manual before requesting visit repair service. Visit repair service is subject to charge. (If repair is not possible, it shall be subject to the separate policy)

Simple case such as product features description or the service not accompanying disassembly of the product.	Paid service from the 2nd time
<ul style="list-style-type: none"> <li>-Failure to install due to movement of product or moving house</li> <li>-When requesting reinstallation of the product which sales conditions had been customer's own installation at the time of purchase.</li> <li>-Reinstalling the product due to the failure of installer</li> <li>-In case Hand Shower /Fixed Shower is broken</li> <li>-In case of product failure or damage due to excessive work during construction</li> <li>-Product's wear due to long-term use</li> </ul>	Paid service from the 1st time

### ② In case of malfunction due to consumer's misuse

- When a malfunction occurs due to carelessness by the consumer or arbitrary repairs or modifications
- In case of a malfunction occurs due to the repairing of unqualified technician
- In case of failure due to the use of non-genuine parts specified by CEBIEN

- Check if there is any installation problem (leakage, water pressure, shaking) before using the product.

**CEBIEN** 세비엔

CEBIEN Co., Ltd. 164-11, Bonggol-gil, Opo-eup, Gwangju-si, Gyeonggi-do, Rep. of Korea  
TEL +82. 31. 765. 3110 FAX +82. 31. 765. 3113 경기도 광주시 오포읍 봉골길 164-11  
WWW.CEBIEN.COM